

LEGEND :

- PROPOSED ROADWORKS:
  - PAVEMENT
  - SHOULDER
  - TABLE DRAIN
  - EARTHWORKS INTERCEPT
- PROPOSED ASPHALT PAVEMENT AND SEMI MOUNTABLE KERB AS DETAILED
- AUXILIARY LANE - BROCKMAN HIGHWAY
- PROPOSED DRAINAGE
  - FUTURE DRAINAGE
  - PROPOSED SIDE ENTRY PIT (SEP)
  - PROPOSED JUNCTION PIT (JP)
  - PROPOSED GRATED GULLY (GG)
  - PROPRIETARY PRECAST CONCRETE HEADWALL
- MORTARED STONE PITCHED SPILLWAY OFF KERB TERMINATION - REFER DETAIL SHEET 13
- PROPOSED LOT CROSSOVER AND CULVERT 800 DEEP TABLE DRAIN - REFER DETAIL SHEET 13
- PROPOSED LOT CROSSOVER AND GULLY WITHIN 300 DEEP TABLE DRAIN REFER DETAIL SHEET 13

GENERAL NOTES - ROAD & DRAINAGE WORKS

1. ALL CONSTRUCTION SHALL BE IN ACCORDANCE WITH THE SPECIFICATION AND THE REQUIREMENTS OF BOTH THE SHIRE OF AUGUSTA MARGARET RIVER AND MAIN ROADS WA
2. PRIOR TO CONSTRUCTION, THE CONTRACTOR SHALL IDENTIFY AND PROTECT ALL EXISTING INFRASTRUCTURE WITHIN AND ADJACENT TO THE WORKS AREA. SHOULD EXISTING AND PROPOSED WORKS INTERSECT, LEVELS ARE TO BE TAKEN AND PROVIDED TO THE SUPERINTENDENT. THE CONTRACTOR SHALL BE LIABLE FOR ALL COSTS OF RECTIFICATION AND OTHER LOSSES RESULTING FROM INTERFERENCE OR DAMAGE THAT OCCURS AS A CONSEQUENCE OF HIS WORK. REINSTATEMENT OF ALL LOCAL AUTHORITY INFRASTRUCTURE SHALL BE CARRIED OUT IN ACCORDANCE WITH IPWEA RESTORATION AND REINSTATEMENT SPECIFICATION.
3. THE CONTRACTOR SHALL PREPARE TRAFFIC AND ENVIRONMENTAL (DUST, NOISE, VIBRATION, A.S.S.) MANAGEMENT PLANS SPECIFIC TO HIS WORK TO BE UNDERTAKEN. ALL PLANS SHALL BE PROVIDED TO AND APPROVED BY THE RELEVANT AUTHORITIES PRIOR TO CONSTRUCTION.
3. THE CONTRACTOR SHALL PROVIDE SUFFICIENT ENGINEERING SURVEY TO MAINTAIN CONTROL OF THE WORKS, BASED UPON CADASTRAL INFORMATION AND BENCHMARKS PROVIDED BY THE PROJECT SURVEYOR. THE PROJECT SURVEYOR SHALL IDENTIFY ON SITE ALL CADASTRAL BOUNDARIES, WHICH SHALL BE PROTECTED AND PRESERVED BY THE CONTRACTOR. REPEGGING OF CADASTRAL BOUNDARIES AND REPLACEMENT OF DISTURBED BENCHMARKS SHALL BE UNDERTAKEN ONLY BY THE PROJECT SURVEYOR AT THE CONTRACTOR'S COST.
4. ALL ROAD CROSSINGS FOR SERVICE INSTALLATION SHALL BE UNDERTAKEN PRIOR TO BASE COURSE CONSTRUCTION.
5. ALL CONSTRUCTION SHALL MAKE SMOOTH AND UNIFORM CONNECTION TO EXISTING WORKS.
6. FIGURED DIMENSIONS SHALL BE READ IN PREFERENCE TO SCALE AND LARGER SCALE DRAWINGS SHALL BE READ IN PREFERENCE TO SMALLER SCALE DRAWINGS OF THE SAME WORK. MINOR DETAILS AND PARTS WHICH ARE NOT INCLUDED ON THE DRAWINGS BUT THE INCLUSION OF WHICH IS CLEARLY TO BE INFERRED AND WHICH ARE OBVIOUSLY NECESSARY FOR THE COMPLETION OF THE WORKS, SHALL BE SUPPLIED AND EXECUTED AT NO ADDITIONAL COST.
7. STORM WATER PIPES ARE TO BE REINFORCED CONCRETE (CLASS 4) BENEATH ROAD PAVEMENTS AND REINFORCED CONCRETE (CLASS 2) ELSEWHERE UNLESS NOTED OTHERWISE.
8. JUNCTION AND SIDE ENTRY PITS ARE TO BE LOCATED IN THE POSITIONS SHOWN, IRRESPECTIVE OF THE INDICATED PIPE LENGTHS. PITS LOCATED IN SAG CURVES ARE TO BE INSTALLED AT THE LOWEST POINT OF THE PAVEMENT.
9. EXCESS SPOIL FROM EARTHWORKS IS TO BE PLACED, SPREAD AND COMPACTED ON SITE AS DIRECTED BY THE SUPERINTENDENT. ROCK AND OTHER UNSUITABLE MATERIAL SHALL BE REMOVED FROM THE SITE. VERGES SHALL BE CUT OR FILLED TO THE GRADES INDICATED, USING IMPORTED FILL WHERE NECESSARY, AND COVERED WITH TOPSOIL. THE FINAL SURFACE SHALL BE TRIMMED TO A NEAT AND TIDY APPEARANCE FREE OF STONES, WHEEL RUTS AND OTHER BLEMISHES.
10. NO VEGETATION IS TO BE REMOVED FROM EXISTING ROAD RESERVES WITHOUT THE WRITTEN PERMISSION OF THE LOCAL AUTHORITY.
11. "AS CONSTRUCTED" DETAILS SHALL BE PROVIDED IN THE FORMAT REQUIRED BY THE RELEVANT AUTHORITY AND APPROVED BY THE SUPERINTENDENT PRIOR TO ANY CLAIM FOR PAYMENT.
12. ANY WORKS FOR WHICH ADDITIONAL PAYMENT WILL BE REQUIRED SHALL NOT BE COMMENCED UNTIL APPROPRIATE VARIATION ORDERS HAVE BEEN PRICED AND APPROVED IN WRITING BY THE SUPERINTENDENT.
13. CONSTRUCTION WORKS SHALL NOT COMMENCE UNTIL PRE START MEETINGS HAVE BEEN CONVENED WITH THE RELEVANT STATUTORY AUTHORITIES.
14. ALL LEVELS ARE TO A.H.D.
15. LINE-MARKING AND SIGNAGE TO BE INSTALLED TO MRWA STANDARDS AND SPECIFICATIONS.
16. PAVEMENT WIDTHS SHALL BE AS INDICATED BY THE DRAWINGS AND MEASURED BETWEEN KERB FACES.
17. VERGES SHALL BE FINISHED WITH 100mm TOPSOIL.
18. VERGES AND DISTURBED AREAS ARE TO BE HYDROMULCHED WITH SEED MIX APPROVED BY THE SUPERINTENDENT.

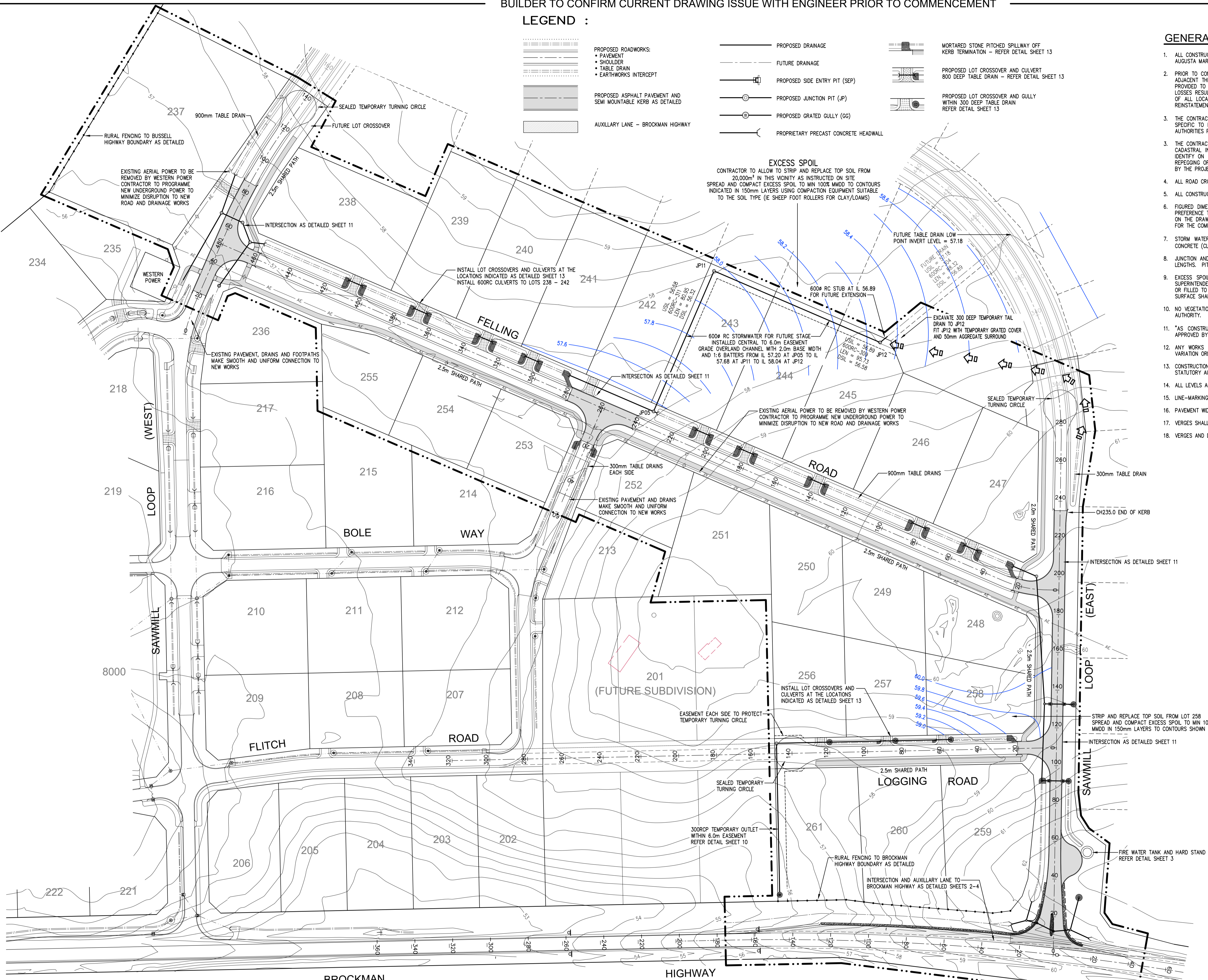

**WORK IN EXISTING ROAD RESERVES**  
 TRAFFIC MANAGEMENT TO BE APPROVED AND IMPLEMENTED IN ACCORDANCE WITH THE REQUIREMENTS OF THE LOCAL AUTHORITY AND MAIN ROADS (WA) CODE OF PRACTICE. REINSTATEMENT OF ALL IMPROVEMENTS TO BE COMPLETED TO THE SATISFACTION OF MAIN ROADS (WA)

**EXISTING SERVICES**  
 CONTRACTOR TO LOCATE IDENTIFY AND PROTECT ALL EXISTING SERVICES WITHIN THE WORKS AREA PRIOR TO COMMENCEMENT OF EXCAVATION. ALL COSTS ASSOCIATED WITH ANY DAMAGE CAUSED TO EXISTING ASSETS SHALL BE BORNE BY THE CONTRACTOR

**DRAINAGE PIPE SPECIFICATION**  
 ALL DRAINAGE PIPES TO BE SPUN REINFORCED CONCRETE CLASS 4 BENEATH ROAD PAVEMENTS AND CLASS 2 ELSEWHERE. PIPES TO BE RUBBER RING JOINTED WITH BELL HOUSING LAID UPSTREAM

**ENVIRONMENTAL PROTECTION**  
 CONTRACTOR TO HAVE DUST MANAGEMENT PLAN AND SOIL STABILIZATION PLAN APPROVED BY THE LOCAL AUTHORITY PRIOR TO COMMENCEMENT

**FENCING**  
 ALL INTERNAL FENCING TO BE REMOVED OFF SITE. ALL PERIMETER BOUNDARY FENCING TO BE REINSTATED IF DAMAGED

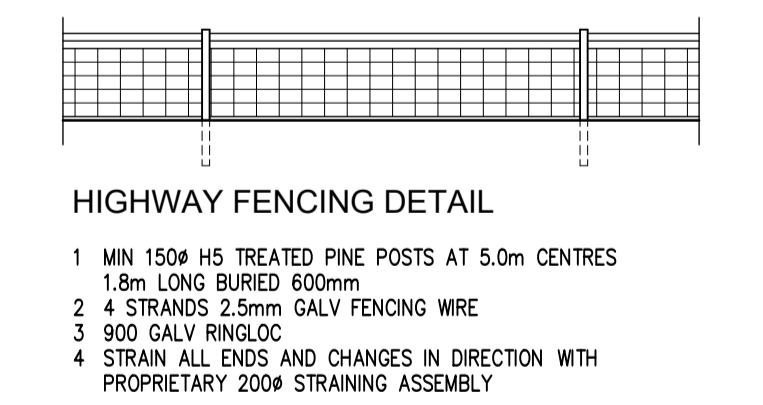

UNIT 14 - 8 EDWARD STREET  
 BUNBURY WA 6230

**JUVENTUS PTY LTD**

THIS DOCUMENT REMAINS THE PROPERTY OF DIRK VAN NOORT

IT SHALL NOT BE USED OR COPIED WITHOUT PERMISSION

TELEPHONE 9792 4355  
 FACSIMILE 9792 4366  
 E-MAIL engineer@dvnet.net.au

THE DOCUMENT REMAINS PRELIMINARY UNTIL ENDORSED "FOR CONSTRUCTION"

PROJECT No MCI01-A-19

SHEET 1 OF 17

REVISION D

LOCAL AUTHORITY AUGUSTA MARGARET RIVER

SCALE 1 : 1000 ( @ A1)

DATUM AHD

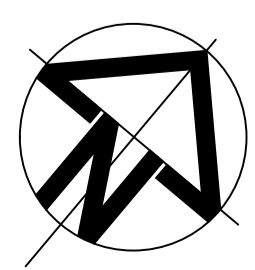

REVISION DATE	No	REVISION DESCRIPTION	DESIGN	DRAWN	CHECKED	APPROVED
12 OCTOBER 2020	0	PRELIMINARY - NOT FOR CONSTRUCTION	DVN	DVN	DVN	
2 DECEMBER 2020	1	ISSUED FOR APPROVAL	DVN	DVN	DVN	
27 JANUARY 2021	A	ISSUED FOR APPROVAL / TENDER	DVN	DVN	DVN	
12 MARCH 2021	B	MINOR AMENDMENTS FOR APPROVAL	DVN	DVN	DVN	
24 MARCH 2021	C	INTERSECTION AMENDMENTS - MRWA	DVN	DVN	DVN	
20 APRIL 2021	D	MRWA STRING ADDED / MINOR DRAINAGE	DVN	DVN	DVN	

PROJECT HAMELIN GROVE SUBDIVISION - STAGE 2  
 LOT 9001 BROCKMAN HIGHWAY KARRIDALE

DRAWING TITLE SUBDIVISION PLAN