

PLAN 17368

P 017368 F 01



LOCAL GOVERNMENT ACT  
ALL ROADS WITHIN THE GREEN  
BORDER ARE NOW DEDICATED.

LOCAL GOVERNMENT ACT  
ALL ROADS WITHIN THE GREEN  
BORDER ARE NOW DEDICATED.

P.A.W / R.O.W as shown on this Survey  
is amended to Lot 155

Regulation 6 Transfer of Land (Surveys) Regulation 1995  
Corr. 1775-2000-01

Date: 15.3.2006

SURVEY OF SUBDIVISION OF PART OF  
SUSSEX LOCATION

724

TOTAL AREA = 19.4087ha  
FBs 58593, 58919, 58920

INDEX PLANS DAWSON 2000 0802  
DAWSON 10000 2-1  
C/T 1782-516  
P.A.W. 1670-431

DEDICATED TOWN PLANNING &  
DEVELOPMENT ACT SEC 28 (3)

LIMITED IN DEPTH TO 60.96 METRES

WALLCLIFFE ROAD  
WIDENING  
RESERVE FOR RECREATION  
NOW MARGARET RIVER  
LOT 260

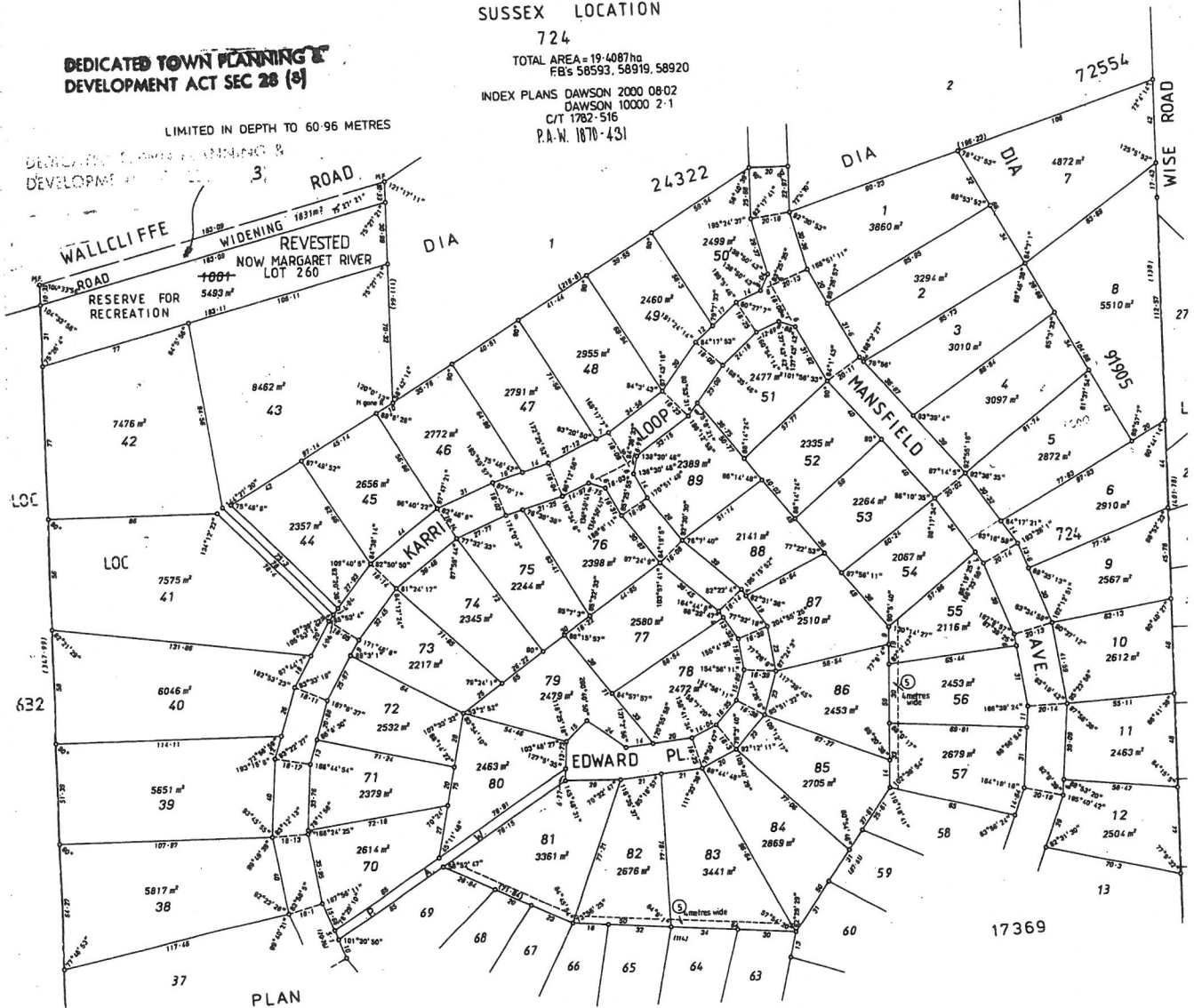

LOT 1001 RESERVE FOR RECREATION AND  
PEDESTRIAN ACCESSWAY TO VEST IN THE CROWN UNDER SEC. 20A.  
OF THE T.P. & D. ACT.

EASEMENT IN FAVOUR OF SHIRE OF AUGUSTA-MARGARET RIVER  
UNDER SECTION 27A T.P. & D. ACT. REG 5

SUBDIVISION  
BY EARLY  
ISSUE PROCESS

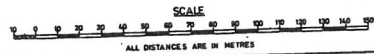

<p>CERTIFICATE OF SURVEYOR</p> <p>JOHN GIUDICE</p> <p>I hereby certify that</p> <p>(a) This survey was performed by me personally or under my personal supervision, inspection and certification in accordance with the Licensed Surveyors (Guidance of Surveyors) Regulations, 1984 or</p> <p>(b) This plan is correct, was prepared under my supervision and is the result of calculations from measurements made by me (or under my own personal supervision, inspection and field checks), in strict accordance with the Licensed Surveyors (Guidance of Surveyors) Regulations, 1984.</p> <p>Date: 14/3/06</p> <p>Licensed Surveyor: <i>[Signature]</i></p>	<p>Approved by State Planning Commission</p> <p>79019 <i>[Signature]</i></p> <p>Date: 14/3/06</p> <p>Chairman</p>	<p>Examined: <i>[Signature]</i> R.A.E.</p> <p>Certified Correct: <i>[Signature]</i> G.S.E.</p> <p>Docket DIA 76839 R.A.E.</p> <p>For Inspector of Plans &amp; Surveys</p>	<p>OFFICE OF TITLES</p> <p>PLAN No.</p> <p>17368</p>
	<p>IN ORDER FOR DEALINGS SUBJECT TO</p> <p>Sec. 285(5) OF TRANSFER OF LAND ACT 1995 &amp; A REGULATION 163(2) FOR INSPECTOR OF PLANS &amp; SURVEYS</p>	<p>APPROVED</p> <p>Inspector of Plans &amp; Surveys</p> <p>27.3.06</p> <p>Date</p>	<p>Registered</p> <p>51670</p> <p>6576</p> <p>16.12.05</p>